

BPX BPDC427

DUAL CIRCUIT BRAZED PLATE HEAT EXCHANGER

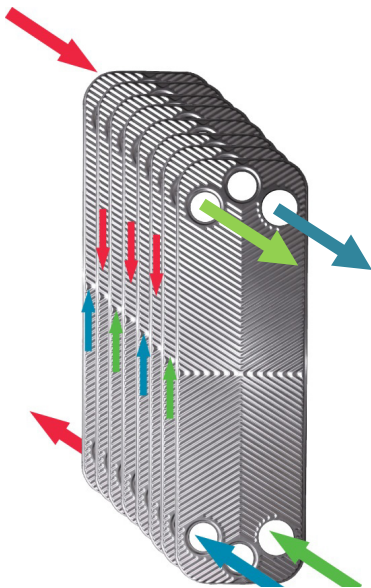

BPX BPDC DUAL CIRCUIT braze plate exchangers offer true two independent refrigerant circuit performance. An engineered plate configuration allows for two separate refrigerant circuits to operate with one common process circuit while maintaining performance during part load operation.

FEATURES

- **True dual circuit construction** for operation with two independent refrigerant circuits.
- **Facilitates operation at partial load** with only one compressor operating maximizing performance.
- **Engineered plate technology** uniformly distributes fluid across the heat transfer surface area optimizing performance and minimizing flow maldistribution.
- **Customized distribution device** based on refrigerant to ensure proper distribution of flow.
- **Suitable for use with all modern refrigerants**



Bell & Gossett

a xylem brand

BPX BPDC427 Dual Circuit brazed plate heat exchanger

Standard Design Data

Maximum design pressure	435, 650 psig options
Maximum design temperature	450F
Minimum number of plates	10
Maximum number of plates	300
Maximum tonnage	200 tons
Flow arrangement	Diagonal

Options

Mounting	Studs, tabs, feet
Connections	NPT/sweat/victaulic
Connection location	Front and back

Standard Material

Plates	Stainless Steel 316
Braze alloy	Copper
Connections	Stainless Steel 316
Cover plates	Stainless Steel 316

Codes

UL	Standard
CRN	Optional
ASME code	Optional
EU PED	Optional

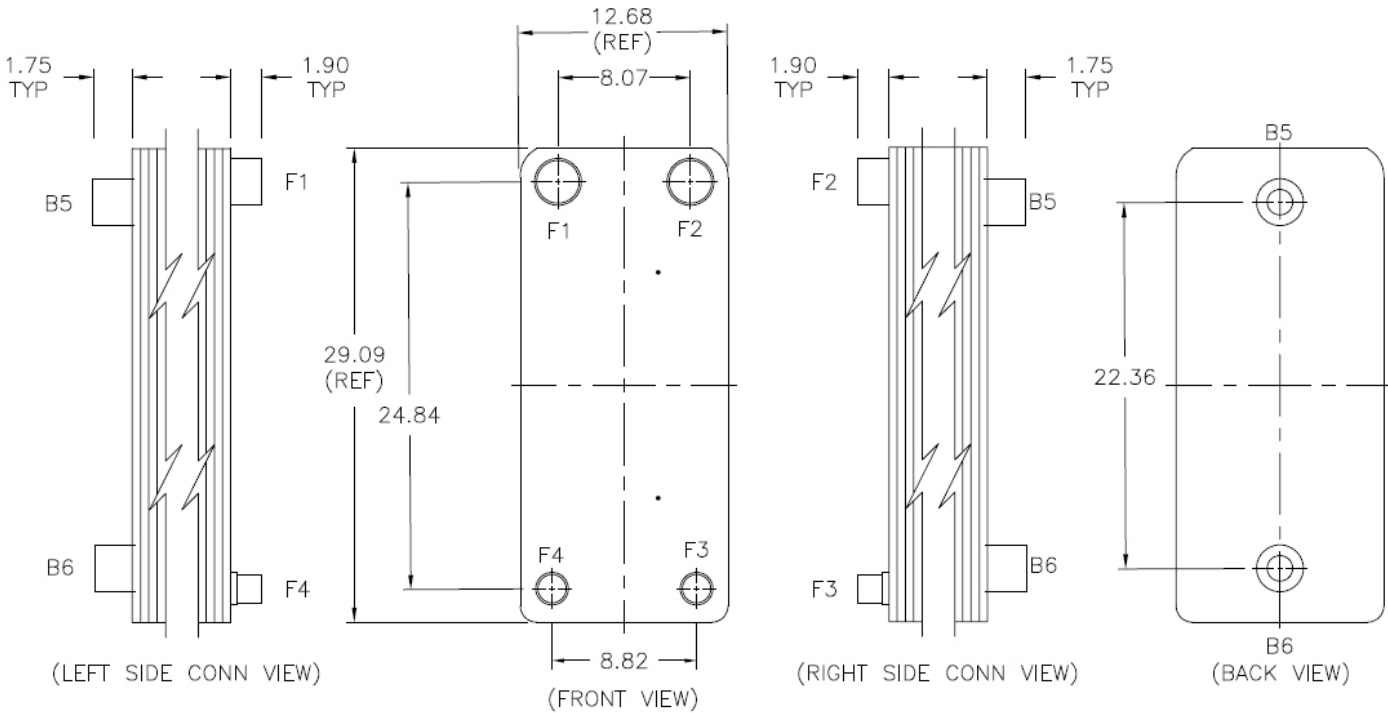

NOTES:

1. DIMENSIONS SHOWN IN INCHES (in).



Xylem Inc.
 175 Standard Parkway
 Cheektowaga, NY 14227
 Phone: (800) 447-7700
 FAX: (716) 862-4176
www.xylem.com/bellgossett

Xylem, Bell & Gossett, Circuit Setter and Circuit Sentry are trademarks of Xylem, Inc. or one of its subsidiaries. All other trademarks are property of their respective owners.
 © 2023 Xylem Inc. BG-BPXBPC427-SS-120044 R2 August 2023

To learn more about heat exchangers:

