



WS_B Series

Model 3886

SUBMERSIBLE SEWAGE PUMP



FEATURES

Impeller: Cast iron, semi-open, dynamically balanced, non-clog with pump out vanes for mechanical seal protection. Optional Silicon bronze impeller available.

Casing: Cast iron volute type for maximum efficiency. Designed for easy installation on A10-20 guide rail or base elbow rail systems.

Mechanical Seal: Silicon carbide vs. silicon carbide sealing faces for superior abrasive resistance, stainless steel metal parts, BUNA-N elastomers.

Shaft: Corrosion-resistant stainless steel. Threaded design. Locknut on all models to guard against component damage on accidental reverse rotation.

Fasteners: 300 series stainless steel.

Capable of running dry without damage to components.

Designed for continuous operation when fully submerged.

Extended Warranty available for residential applications.

AGENCY LISTINGS



Tested to UL 778 and CSA 22.2 108 Standards
By Canadian Standards Association
File #LR38549

APPLICATIONS

Specifically designed for the following uses:

- Homes
- Sewage systems
- Dewatering/Effluent
- Water transfer

SPECIFICATIONS

Pump

- **Solids handling capabilities:** 2" maximum
- **Discharge size:** 2" NPT
- **Capacities:** up to 185 GPM
- **Total heads:** up to 38 feet TDH
- **Temperature:** 104°F (40°C) continuous, 140°F (60°C) intermittent

MOTORS

- Fully submerged in high grade turbine oil for lubrication and efficient heat transfer. All ratings are within the working limits of the motor.
- Class B insulation

Single phase (60 Hz):

- All single phase models feature capacitor start motors for maximum starting torque.
- Built-in overload with automatic reset.
- SJTOW or STOW severe duty oil and water resistant power cords.
- 1/3 - 1 HP models have NEMA three prong grounding plugs.

Three phase (60 Hz):

- Class 10 overload protection must be provided in separately ordered starter unit.
- STOW power cords all have bare lead cord ends.
- **Bearings:** Upper and lower heavy duty ball bearing construction.
- **Designed for Continuous Operation:** Pump ratings are within the motor manufacturer's recommended working limits, can be operated continuously without damage when fully submerged.
- **Power Cable:** Severe duty rated, oil and water resistant. Epoxy seal on motor end provides secondary moisture barrier in case of outer jacket damage and to prevent oil wicking. Standard cord is 20'. Optional lengths are available.
- **Motor Cover O-ring:** Assures positive sealing against contaminants and oil leakage.

MODELS

Order Number	HP	Phase	Volts	RPM	Impeller Diameter (in.)	Maximum Amps	Locked Rotor Amps	KVA Code	Full Load Efficiency	Resistance		Weight (lbs.)
										Start	Line-Line	
WS0311B	0.33	1	115	1750	4.69	10.7	30.0	M	54	11.9	1.7	63
WS0318B			208			6.8	19.5	K	51	9.1	4.2	
WS0312B			230			4.9	14.1	L	53	14.5	8.0	
WS0511B	0.5	1	115		5.00	14.5	31.1	J	55	9.3	1.4	65
WS0518B			208			8.0	19.5	K	51	9.1	4.2	
WS0512B			230			7.3	16.5	J	54	11.7	5.6	
WS0538B		3	200			3.8	12.3	K	75	NA	6.7	
WS0532B			230			3.3	9.7	K	75	NA	9.9	
WS0534B			460			1.7	4.9	K	75	NA	39.4	
WS0537B	575	1.4	4.3		K	68	NA	47.8				
WS0718B	0.75	1	208		5.38	11.0	39.0	K	65	2.6	1.4	85
WS0712B			230			9.4	24.8	J	57	4.8	2.3	
WS0738B		3	200	4.1		21.2	H	74	NA	4.3		
WS0732B			230	3.6		17.3	J	76	NA	5.6		
WS0734B			460	1.8		8.9	J	76	NA	22.4		
WS0737B			575	1.5		7.3	J	71	NA	29.2		
WS1018B	1	1	208	5.75	14.0	39.0	K	65	2.6	1.4		
WS1012B			230		12.3	30.5	H	60	4.3	1.8		
WS1038B		3	200		6.0	21.2	H	74	NA	4.3		
WS1032B			230		5.8	17.3	J	76	NA	5.6		
WS1034B			460		2.9	8.9	J	76	NA	22.4		
WS1037B			575		2.4	7.3	J	71	NA	29.2		

CURVES

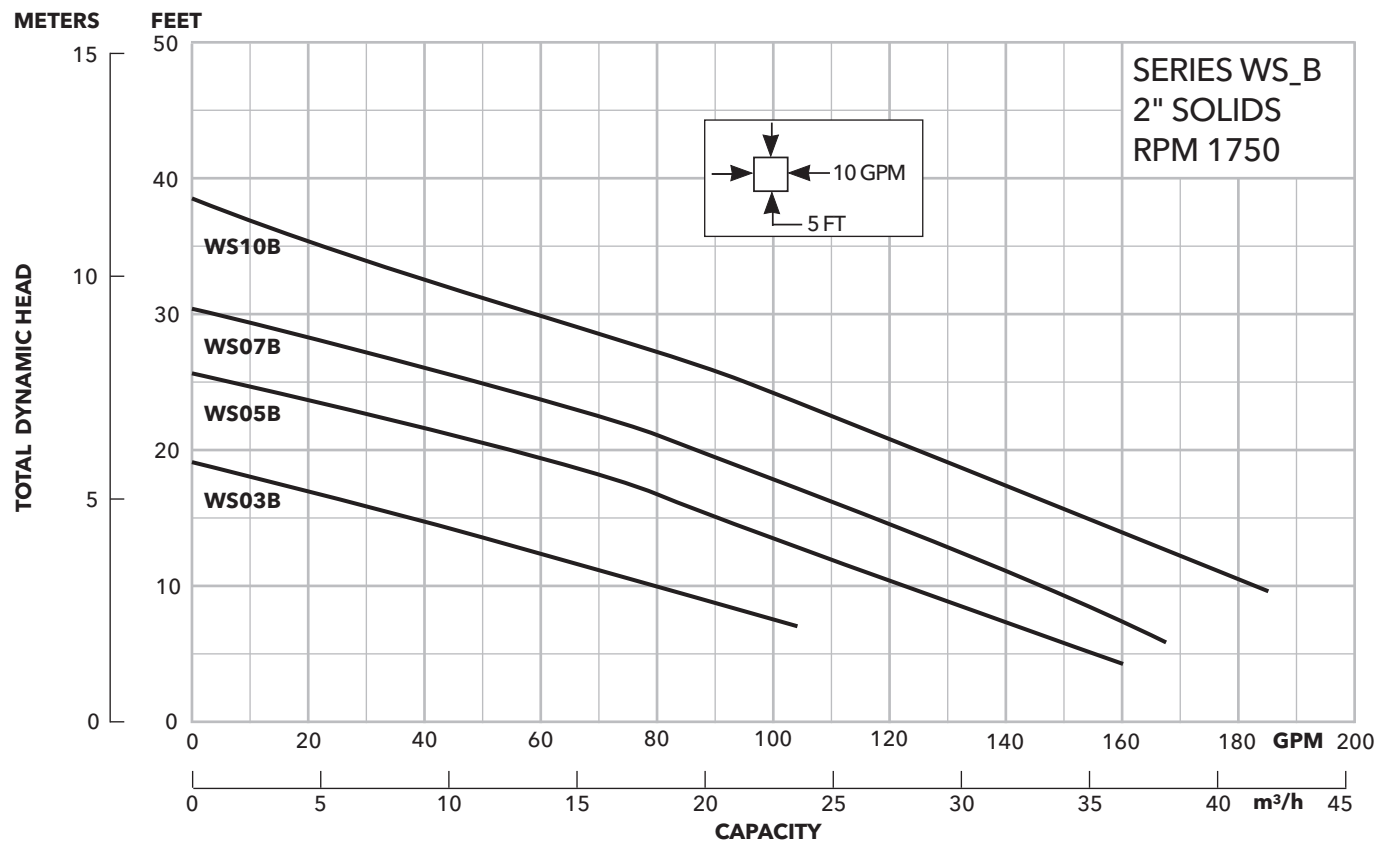

COMPONENTS *(for reference only)*

Item No.	Description
1	Impeller
2	Casing
3	Mechanical Seal
4	Motor Shaft
5	Motor
6	Ball Bearings
7	Power Cable
8	Casing O-Ring

NOTE: For specific parts breakdown, see repair parts.

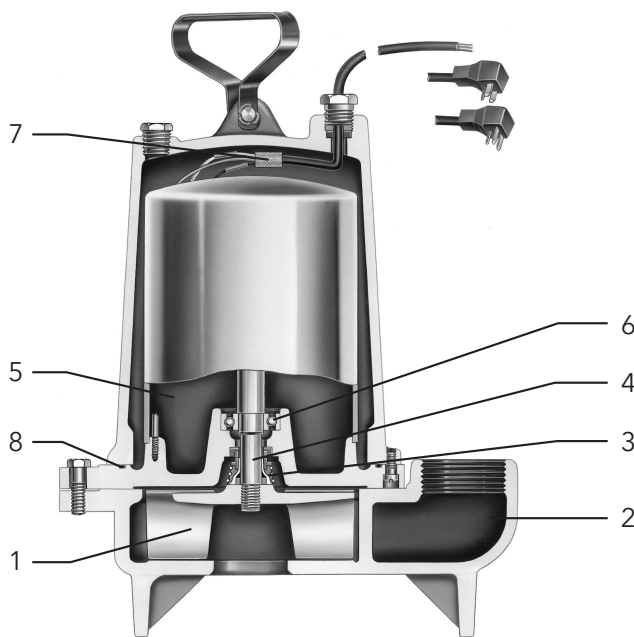

PERFORMANCE RATINGS (gallons per minute)

Order No.	WS03B	WS05B	WS07B	WS10B
HP	1/3	1/2	3/4	1
RPM	1750	1750	1750	1750
Total Head Feet of Water				
10	80	122	145	183
15	36	90	116	152
20	-	50	86	123
25	-	-	48	95
30	-	-	-	58
35	-	-	-	20

DIMENSIONS

(All dimensions are in inches. Do not use for construction purposes.)

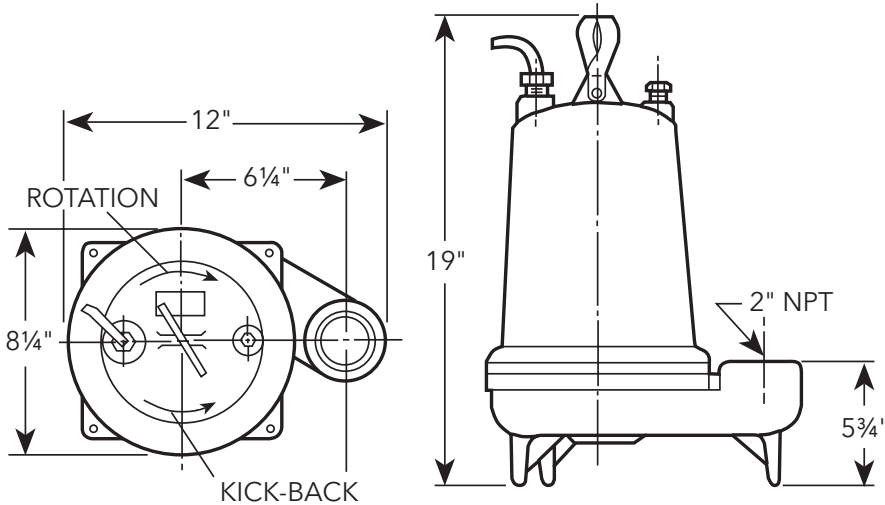

PUMP-TO-PANEL PART NUMBERS

Pump	HP	Phase	Voltage	Amps	Simplex Panel	Duplex Panel
WS0311B	0.33	1	115	10.7	C4S10020	C4D10020
WS0318B	0.33	1	208	6.8	C4S10020	C4D10020
WS0312B	0.33	1	230	4.9	C4S10020	C4D10020
WS0511B	0.5	1	115	14.5	C4S10020	C4D10020
WS0518B	0.5	1	208	8	C4S10020	C4D10020
WS0512B	0.5	1	230	7.3	C4S10020	C4D10020
WS0538B	0.5	3	200	3.8	C4S32540	C4D32540
WS0532B	0.5	3	230	3.3	C4S32540	C4D32540
WS0534B	0.5	3	460	1.7	C4S31625	C4D31625
WS0537B	0.5	3	575	1.4	C4S31625	C4D31625
WS0718B	0.75	1	208	11	C4S10020	C4D10020
WS0712B	0.75	1	230	9.4	C4S10020	C4D10020
WS0738B	0.75	3	200	4.1	C4S34063	C4D34063
WS0732B	0.75	3	230	3.6	C4S32540	C4D32540
WS0734B	0.75	3	460	1.8	C4S31625	C4D31625
WS0737B	0.75	3	575	1.5	C4S31625	C4D31625
WS1018B	1	1	208	14	C4S10020	C4D10020
WS1012B	1	1	230	12.3	C4S10020	C4D10020
WS1038B	1	3	200	6	C4S34063	C4D34063
WS1032B	1	3	230	5.8	C4S34063	C4D34063
WS1034B	1	3	460	2.9	C4S32540	C4D32540
WS1037B	1	3	575	2.4	C4S32540	C4D32540

SERIES "CORE 4" CONTROL PANELS

Series "Core 4" Control Panels provide outstanding, automatic, liquid level control to help manage and maintain pump operation for a variety of effluent, sewage, and water transfer applications.

FEATURES

- Rugged, NEMA 4X construction withstands even the most severe weather conditions and prevents corrosion
- Solid-state control board displays float status for ease of installation and trouble-shooting
- Hinged door with lockable stainless-steel latch for safe operation indoors and out
- Through-door mounted alarm test switch ensures proper operation of the alarm circuit without the need to open the panel
- Panel can be wired for a single power feed and control circuit, or the control circuit can be wired to a separate power supply to ensure alarm integrity in case of a tripped pump breaker
- Top-mounted, high intensity, flashing red light provides 360° visibility
- Auxiliary alarm contacts provided for remote alarm connection
- Field wiring diagram, panel schematic and installation instructions included
- Entire unit is UL and CUL listed

PRODUCT SPECIFICATIONS

- Hand-off-automatic (H-O-A) pump selection switch(es)
- On-off control circuit switch
- Float switches:
 - Normally open (pump down) mechanical float switches with 20' cords
 - Simplex panels (three switches)
 - Duplex panels (four switches)
- Duplex panels include alternation
- NEMA 4X:
 - Flashing red alarm light
 - Fiberglass enclosure with gasketed, hinged door and stainless-steel hardware
 - Alarm horn (95db)
- Solid state printed circuit control board with float indicator lights
- Auxiliary alarm dry contact
- Elapsed time meter(s)
- Cycle counter(s)
- Single Phase
 - Field adjustable for 115 or 230V, 60Hz
- Three Phase
 - Field adjustable for 208/230/460/575 V, 60 Hz
 - 115V control circuit transformer
 - Adjustable motor overload protectors



Xylem |'zīləm|

- 1) The tissue in plants that brings water upward from the roots;
- 2) a leading global water technology company.

We're a global team unified in a common purpose: creating advanced technology solutions to the world's water challenges. Developing new technologies that will improve the way water is used, conserved, and re-used in the future is central to our work. Our products and services move, treat, analyze, monitor and return water to the environment, in public utility, industrial, residential and commercial building services settings. Xylem also provides a leading portfolio of smart metering, network technologies and advanced analytics solutions for water, electric and gas utilities. In more than 150 countries, we have strong, long-standing relationships with customers who know us for our powerful combination of leading product brands and applications expertise with a strong focus on developing comprehensive, sustainable solutions.

For more information on how Xylem can help you, go to www.xylem.com

<p>COMPLETE. RELIABLE. BLUE.</p> <p>Learn more about our complete line of wastewater products.</p>	
---	--



Xylem Inc.
2881 East Bayard Street Ext., Suite A
Seneca Falls, NY 13148
Phone: (866) 325-4210
Fax: (888) 322-5877
www.xylem.com/goulds

Xylem is a registered trademark of Xylem Inc. or one of its subsidiaries. Goulds is a registered trademark of ITT Manufacturing Enterprises LLC and is used under license. All other trademarks or registered trademarks are property of their respective owners.

© 2024 Xylem Inc. B3886 R4 September 2024